

## PCIe x4 to 2-Port USB 3.2 Gen II USB-C with Mini DP Input Expansion Card

EC365

User Manual

*Simplify Your Life*

www.simplecom.com.au

## Features

- 2-Port USB-C PCIe card with miniDP input for video passthrough
- One USB-C port supports DP Alt Mode for data and video output
- miniDP input supports video resolutions up to 4K@60Hz
- Compatible with USB-C docking stations with video output capability
- USB-C video output supports resolutions up to 4K@60Hz
- PCIe x4 interface, compatible with x8 or x16 slots
- USB 3.2 Gen 2 interface delivers data transfer speeds up to 10Gbps
- Each USB port features built-in over-current protection
- Powered directly by PCIe, no external power required
- Integrated PCIe 12V-to-5V power module for stable USB operation
- Plug and play with Windows 10 or later

## Specifications

- **PCIe Interface:** PCIe 3.0 x4, compatible PCIe x8 or x16 slot
- **USB Standard:** USB 3.2 Gen 2, up to 10Gbps
- **Ports:** 1× USB-C (Data only), 1× USB-C (Data + Video), 1× miniDP (Input)
- **USB Power Output:** 5V/2A
- **Video Input Resolution:** Up to 4K@60Hz (via miniDP)
- **Video Output Resolution:** Up to 4K@60Hz (via USB-C with DP Alt Mode)
- **Power Source:** Integrated PCIe 12V to 5V module
- **OS Support:** Windows 10 and later

## Overview

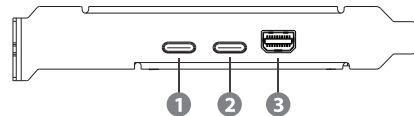

1. USB-C 1 (Data Only 10Gbps)
2. USB-C 2 (Data 10Gbps and Video Output)
3. Mini DisplayPort **(INPUT)\***

*\*Connect to the DP port on the motherboard or graphics card; the video signal will then pass through to the USB-C 2 port.*

## Important Notes

- The miniDP port functions as a video input only.
- The miniDP port must be connected to the DisplayPort output on your motherboard or graphics card, the video signal will then pass through to the USB-C 2 port.
- Please note that this expansion card does not include a graphics processor, the USB-C video output is passed through from the miniDP input port.
- The USB-C 1 port supports data transfer only and does not support video output.
- If you plan to connect the mini DP port to the DisplayPort on your motherboard, please ensure your CPU has integrated graphics.

## Installation

1. Turn off your PC and disconnect the power cable.
2. Open your PC case and insert the PCIe card into a PCIe x4, x8, or x16 slot on the motherboard.

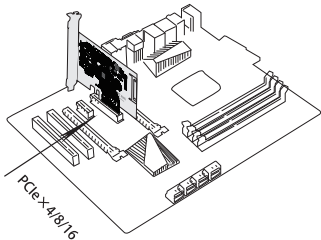

3. Fasten the metal bracket with a screw to secure the card in the PCIe slot.

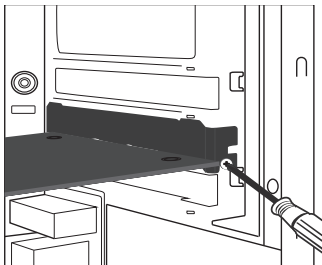

3. Connect the miniDP port to the DisplayPort output on your motherboard or graphics card, the video signal will then pass through to the USB-C 2 port.



## Safety Information

Please disconnect the PC from power before installation. During PC component assembly, all cables must be disconnected from the computer, as failure to do so may cause electric shock or damage to PC components.

When installing PC component cards, please note that ESD (electrostatic discharge) can damage the PC. To prevent this, touch a grounded metal object to discharge static electricity or wear antistatic gloves before installation.

## Package Contents

- 1x PCIe Expansion Card
- 1x Low Profile Bracket
- 1x miniDP to DP Cable

## Warranty

1 Year limited Warranty. Our goods come with guarantees that cannot be excluded under the Australian Consumer Law. You are entitled to a replacement or refund for a major failure and for compensation for any other reasonably foreseeable loss or damage. You are also entitled to have the goods repaired or replaced if the goods fail to be of acceptable quality and the failure does not amount to a major failure.

For our assistance with regards to warranty please email to [support@simplecom.com.au](mailto:support@simplecom.com.au) or create a support ticket at <http://www.simplecom.com.au>

© Simplecom Australia All Rights Reserved. Simplecom is a registered trademark of Simplecom Australia Pty Ltd. All other trademarks are property of their respective owner. Specifications and external appearance are subject to change without notice. Warranty and technical support covering this product are only valid in the country or region of purchase.